

## Instruction Guide

### Klick-Fit Curtain Pole Kit

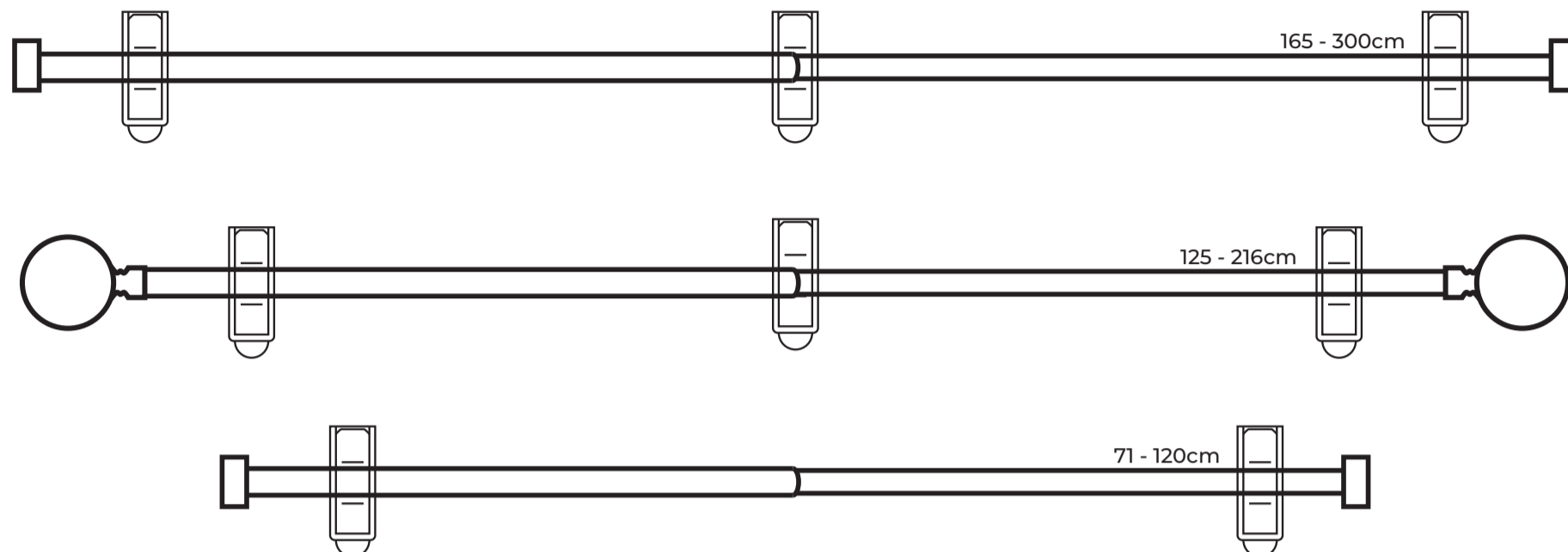

v1-110325

## Before You Start



Before installing please identify that you have all the kit parts as listed below.

### Warnings

- Proper fitting of this item is extremely important.
- This is suitable for DIY fitting however if the necessary tools and expertise are not available, we would recommend installation by a qualified tradesperson.
- Ensure that your wall is in sound condition prior to fitting & check that no hidden pipes or cables will interfere when installing.
- We suggest you retain these instructions for future reference. This product should only be used on solid mounting at the point of fixing. This is necessary to take the weight of the curtain pole with curtain. Please periodically check all fittings and re-tighten as necessary.
- Unwrap all packaging material and place the components on top of the carton box or on a clean floor to protect from damage.
- The included screws & wall plugs provided are for plasterboard partitions or masonry walls.

### Do's

- We suggest you spend a short time reading through this leaflet before you start. When you are ready to start, make sure that you have the right tools and plenty of space.
- Carefully check that you have all the parts before beginning assembly.
- Due to the size of the product we recommend that it is assembled in the room intended for use.
- Ensure the product is fully assembled as illustrated and all fixings are fully tightened before use.
- Wipe occasionally with a clean soft cloth lightly.
- Ensure eye protection is used worn throughout the installation.

### Dont's

- Do not use abrasive materials as these will rub away the protective coating.

## Kit Parts Included

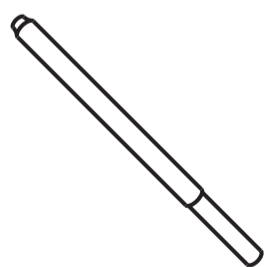

1x  
Extendable  
Curtain Pole



2X - 71-120cm  
3X - 125-216cm  
3X - 165-300cm  
3X - 280-400cm  
Klick-Fit  
Brackets

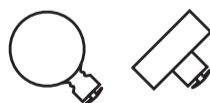

2x  
Push-Fit  
Finials



4X - 71-120cm  
6X - 125-216cm  
6X - 165-300cm  
6X - 280-400cm  
5mm x 40mm  
Wall Screws



4X - 71-120cm  
6X - 125-216cm  
6X - 165-300cm  
6X - 280-400cm  
Suitable  
Wall Plugs

## Tools that you might need

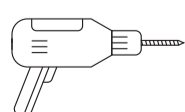

6.5mm Drill Bit  
Cordless  
Drill

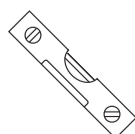

Spirit  
Level

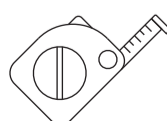

Measuring  
Tape

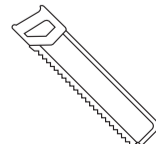

Fine-Toothed  
Hacksaw

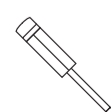

Phillips  
Screw Driver



Low-Tack  
Tape

### Step 1

Measure at least **10cm** across from the window edge and **10cm** up using a pencil mark the bottom of the **Back Plate** of the **Bracket**.  
**\*All Backplates should be at the same height\***

### Step 2

Using a spirit level check the **Back Plate** is straight and mark the holes using a pencil.

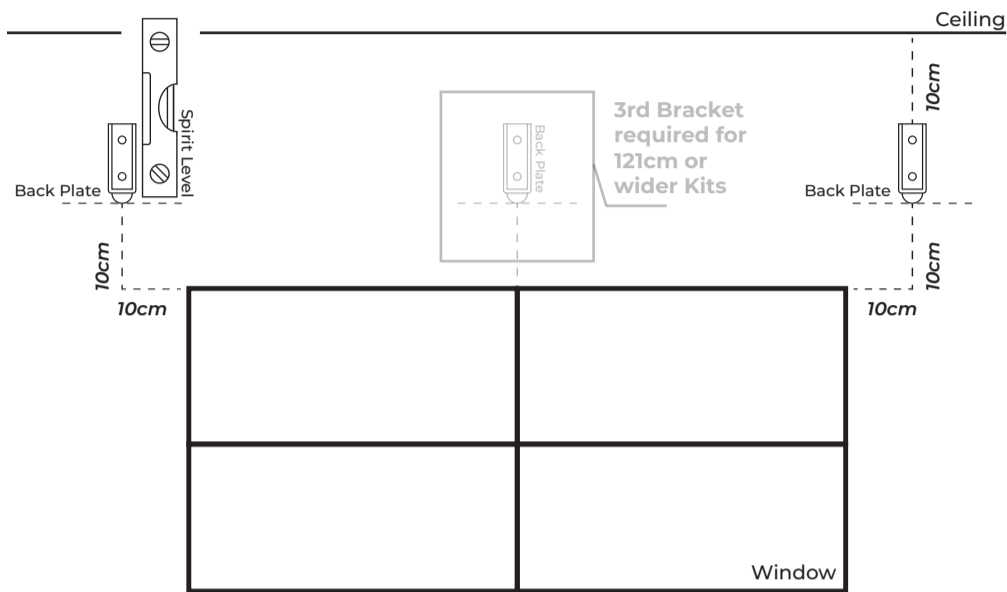

### Step 3

Drill **40mm** deep holes using a **6.5mm** drill bit.

**\*Making sure to keep the drill parallel with the wall at all times\***

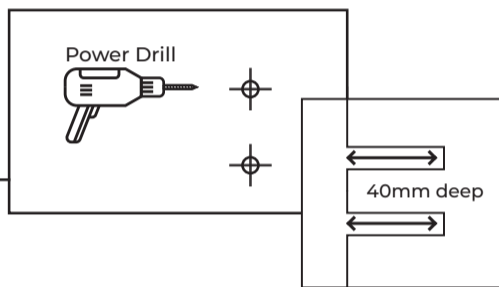

### Step 4

Insert the **Wall Plugs** into the holes and screw the backplates to the wall.

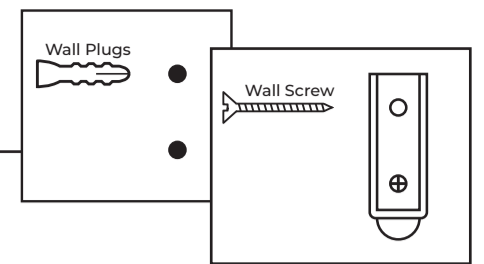

### Step 5

**TIP:** You will require a minimum of **9.7cm** clearance from the top of the backplates to the underside of the ceiling to install the brackets if **9.7cm** clearance is not achievable, please carry out the following:

- 1/ Remove the bottom screw on the backplate.
- 2/ Slightly loosen the top screw.
- 3/ Carefully rotate the backplate either clockwise or anticlockwise (Be careful not to damage the wall when rotating the backplate)
- 4/ Insert the bracket and return the backplate to the vertical position ensuring the bottom hole is aligned with the previous fitted wall plug.
- 5/ Insert screw and tighten the backplate to the wall

**Note:** The minimum clearance from the top of the Backplate and underside of the ceiling is **3.7cm**, any less than this the Bracket cannot be fitted.

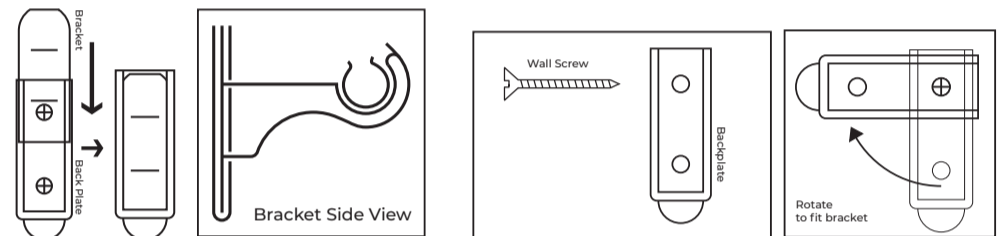

**NOTE:** MINIMUM CLEARANCE REQUIRED BETWEEN THE TOP OF THE BACKPLATE TO THE CEILING IS **37MM**

### Step 6

Take the **Extendable Curtain Pole** and pull on the smaller pole to resize it to your desired length.

**\*If you have small window you will need to cut it to fit\***

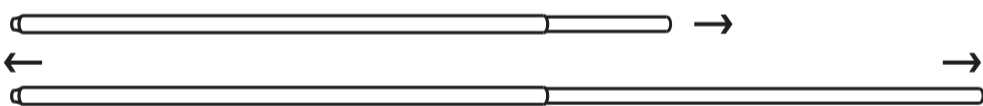

#### TIP FOR CUTTING THE POLE

Use a low-tack tape around the pole, covering the position of the intended cut, to prevent the hacksaw blade from slipping and scratching the Curtain Pole.



**\*If cutting a minimum length of 75mm should be inserted into the pole. Please use a fine-toothed hacksaw for the best results\***

### Step 7

For curtains with eyelets thread the pole through the eyelets leaving one eyelet to the left of the support **Bracket**, on the left-hand side of the pole, and one eyelet to the right of the support **Bracket**, on the right-hand side of the pole, to hold the curtain in place.

#### Step 7.1

For curtain rings slide them on the pole, keeping two aside to be placed on each side of the **Brackets**.



### Step 8

Rest the pole across the wall **Brackets** then simply "**Klick**" into place.

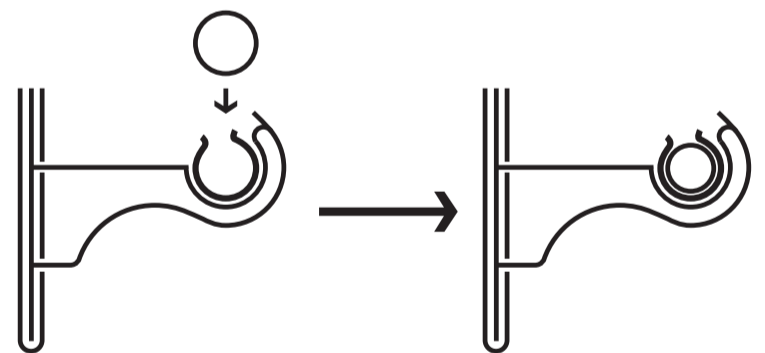

### Step 9

Finally each **Push-Fit Finial** should be placed on each end of the **Curtain Pole** until it's fully inserted onto the pole. It may require twisting as you push them into place.

**\*Repeat this step on both ends of the pole\***

