

ROTHLEY

1.2m

Instruction Guide Acrylic Handrail Kit

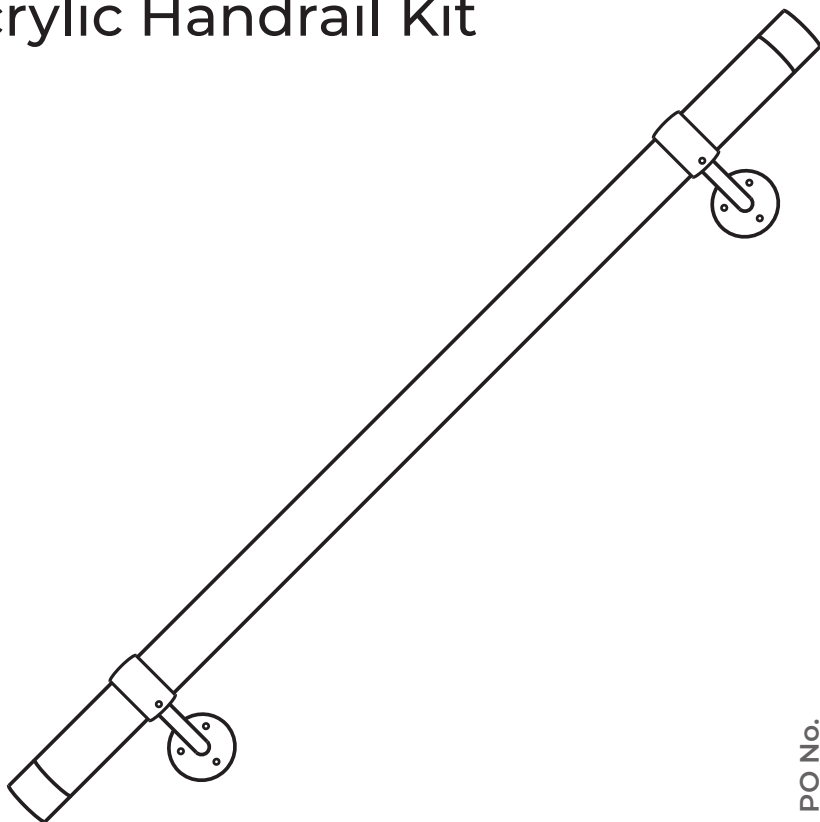

@RothleyLtd



v1-040724

PO No.

Accessorising your home

www. Rothley.com

IMPORTANT INFORMATION

Before Installing please identify that you have all the kit parts as listed on page 2.

Rothley Handrail kits are designed for domestic use ONLY.

Rothley Handrail Kits are suitable for indoor use ONLY.

Before installing please check the wall surface is solid and in sound condition.

Wall Plugs included are for use in solid masonry walls ONLY and may not be suitable for your application. Please ensure you use the correct wall plugs suitable for your application.

Before drilling ensure there are NO pipes or cables located in the wall that could interfere with installation.

Handrail should NOT be fitted to plasterboard partitioning.

Kit Parts

Included

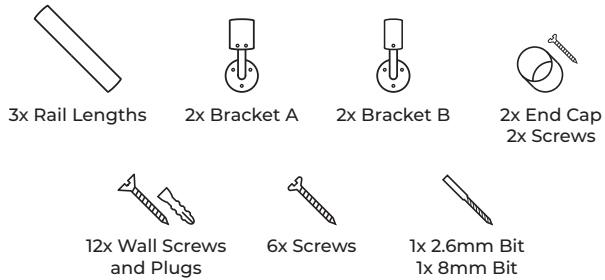

Required Extras

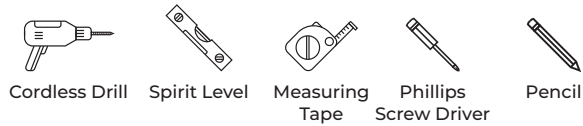

Step 1

Using a pencil and Spirit Level mark 3 points vertical lines on the wall at the bottom, top & centre of the stairs that are 805mm from the edge of the step.

Using a straight edge connect the points together until you have a unobtrusive line that goes from the bottom to the top of the stairs.

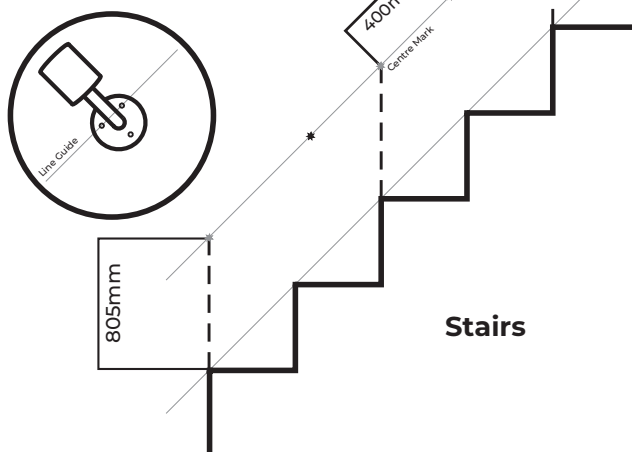

Step 2

Locate the centre position of the stairs and measure 400mm in the elevated position and use the three holes on the base of the Bracket to mark the holes with a pencil.

****top two holes should follow the line guide****

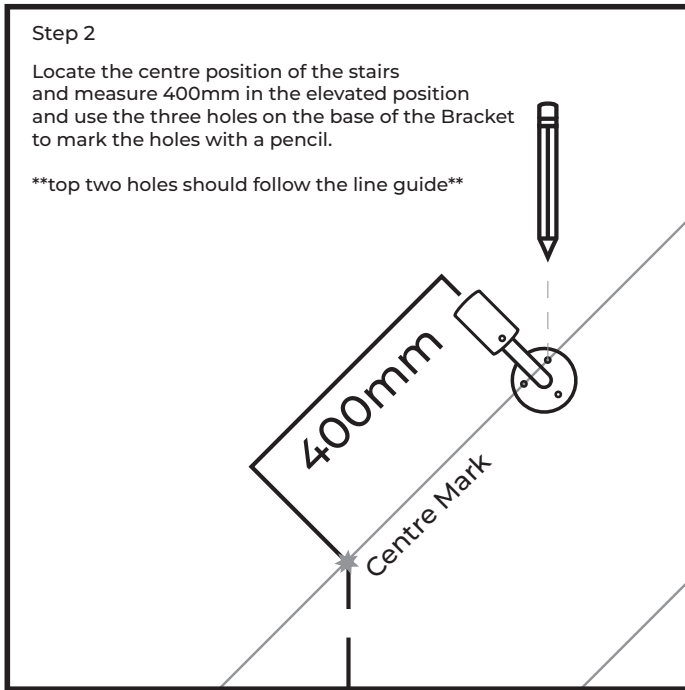

Step 3

Using a Drill with a 8mm bit, drill holes 50mm deep and insert the included wall plugs.

****wall plugs included are for use in solid masonry walls ONLY and may not be suitable for your application. Please ensure you use the correct wall plugs suitable for your application.****

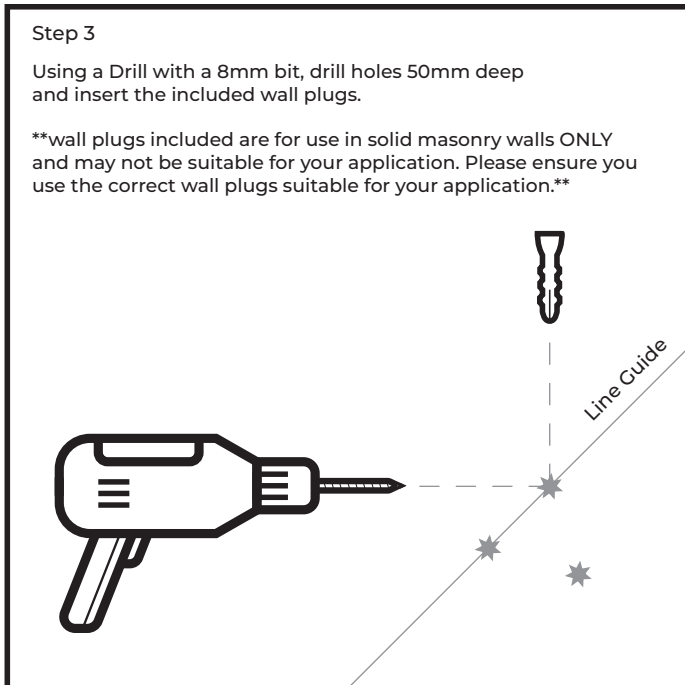

Step 4

Now return the Bracket to the wall and insert the 50mm screws checking they are tight.

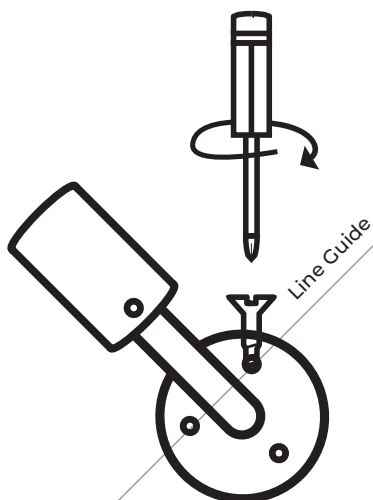

Step 5

Place a length of Handrail into the installed Bracket and another 2nd Bracket onto the end of the Rail.

Align the top two holes on the Bracket with the line guide and mark all three fixing holes on to the wall.

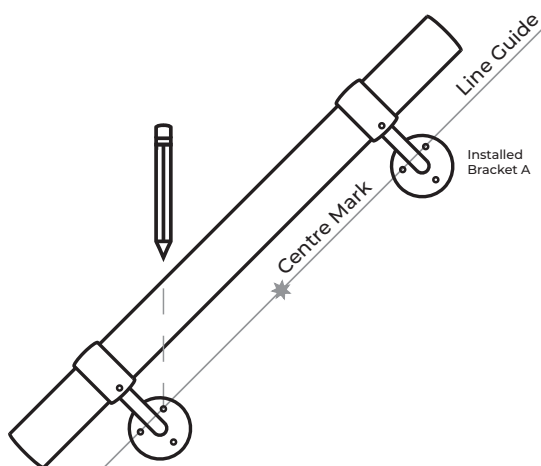

Step 6

Drill all three 8mm x 50mm Deep holes into the wall and insert Wall Plugs included.

Re-insert the Rail and Bracket A onto the end of the Rail and screw Bracket A to the wall.

****Ensure screws are tight****

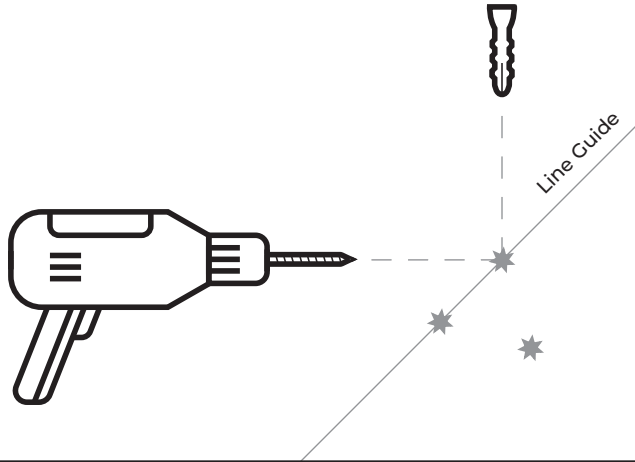

Step 7

Using a 2.6mm Drill Bit, make a pilot hole 20mm deep like shown and insert the Screws. Repeat this on the other end of the Rail to stop the Rail from rotating.

****Ensure the screws are tight****

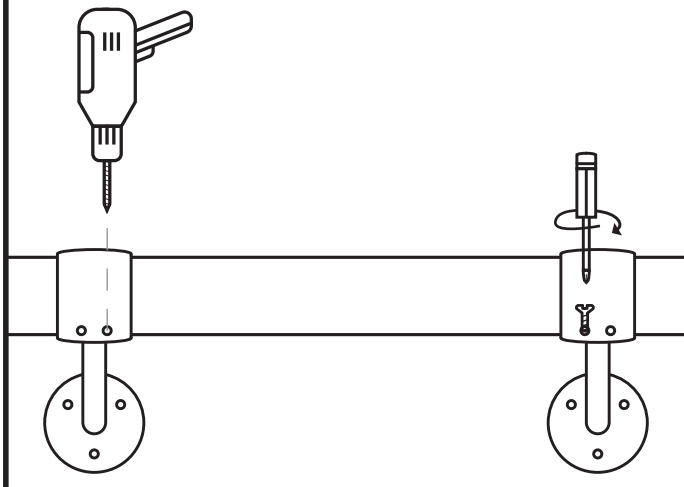

Step 11

This is how it show now look . If not please re-read the instructions

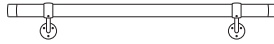

Place the End Caps on the ends of the Handrail, using a pencil mark the pilot hole.

Remove the End Caps and Drill a 2.6 mm x 20mm Deep hole.

Place the End caps back onto the Handrail and Install the Screw making sure it is tight.

****Do this to both ends of the Handrail****

